

FOR YOUNG TRAVELLERS • MADE BY LOCALS

# BRNO

FREE MAP



## Gregor Johann Mendel edition

**Birth day:** 20<sup>th</sup> July, 1822  
**Hometown:** Hynčice (132km from Brno)  
**Nickname:** JGM or Father of modern genetics  
**Languages:** German and Czech  
**Occupation:** priest, teacher, scientist  
**Role models:** Christian Doppler (his teacher at uni in Vienna), Charles Darwin (sadly has never met him in person)  
**Hobbies:** walks by Špilberk castle, beekeeping, working on scientific breakthroughs

Explore places related to Gregor Johann Mendel in the new map of Brno and let's pay a tribute to the person who is known as "the father of genetics".  
 Let's celebrate his 200<sup>th</sup> anniversary together with us in Mendel's Brno.  
 See the other side of this map!

# BRNO IS IN OUR DNA!

How to recognize a true Brnon - a person who lives and breathes for Brno? It is not about where you were born or what language you speak, it is more about where your heart is. Here are some of the qualities people admire (or maybe hate) about people of Brno:

## Patriotism

We love and support our hockey team *Komet*, even during the seasons when they suck. Also, if you were born



## Being "štamgast"

We all have our favourite pubs where we feel like home and are regulars. We have stuck with our pub owners through thick and thin, even if it means to drink the beer out of a plastic cup on a street in freezing cold weather hiding from the police. Thanks Corona, for making our relationship with beer even stronger. We celebrate or we share our sorrows over a pint of beer, we make friends by going out to having some beers. We enjoy having long, cheerful, and often philosophical talks over some beers, and then peacefully go home so we can go to work the next day.

## Self-deprecating humor

Explore places related to Gregor Johann Mendel in the new map of Brno and let's pay a tribute to the person who is known as "the father of genetics".  
 Let's celebrate his 200<sup>th</sup> anniversary together with us in Mendel's Brno.  
 See the other side of this map!

### 1 Castle on the hill?

*Špilberk castle* (or *špilka* as we locally call it), was initially built in the 13<sup>th</sup> century and has quite an interesting history. It was first constructed to protect the city and indeed it survived the Swedish threat in 1645. Later, it was turned into a prison and then into military barracks. Today, it serves as a museum, mostly known for its dungeons and torture exhibition. Also, many theatre performances, concerts and festivals are held there, such as the open-air cinema or the Summer Shakespeare Festival. A park surrounding the castle serves as a chill-out zone with beautiful views and it's ideal for a nice stroll if you don't mind walking up the hill. Also hidden there is Brno's only Orthodox church of St. Wenceslas, easily recognizable by its golden dome.

*Špilberk 210* - Tue to Sun 09:00-17:00, Apr to Sep open also on Mondays

### 3 Follow you nose

The smell of freshly baked croissants and bread from *William Thonard Artisan Bakery* fills the entire street. Watch the bakers at work folding pastries and buy an almond croissant or a poppy seed pastry with plum marmalade. Or maybe the unusual version with bacon. You will not regret it. Now you can enjoy them in the newly opened bakery in the city centre where you can sit at the cosy place at the window overlooking the *Jozefská* street and have a cup of coffee accompanying your pastry.

*Jozefská 2* - Tue to Fri 07:30-18:30  
*U Ještěka 2* - Mon to Fri 07:30-18:30  
*Hvozdky 7* - Mon to Fri 07:30-20:00

Local tip

### 2 Market with tradition

*Zelový trh* (cabbage market) may look small, but it does serve as an important open-space market offering seasonal fruit, vegetable and flowers and is also the hub for popular beer festivals, flea markets or a beautiful Christmas market in December. In summer you can enjoy here a scoop of delicious vegan ice-cream from the truck of *Bobek Kopeček*, we recommend trying their lavender and blueberry flavour. At the same square you find the building of the market place (Tržnice) that was re-opened in 2017. You'll come across bakeries, cafes, bistros, and pubs but also some small stalls with traditional cheese, beers, sausages, and spices. One of the events that regularly takes place here is the *flint market* - event that connects people who like to sell and buy various quality clothes, accessories, or some delicacies. [www.flintmarket.cz](http://www.flintmarket.cz)

Mon to Fri 06:00-18:00, Sat 06:00-11:00, open Mon to Nov

### 4 Astronomical Clock

This controversial clock was built in 2010 and people have been discussing its design ever since. We're still trying to figure out how to read the time on it. The clock was built as a reference to the year 1645, when Brno was besieged by the Swedes. As one legend has it, the Swedish general Torstensson bragged about Brno being conquered by noon, otherwise his army would leave. However, the clever people of Brno rang the bells of Petřov Cathedral an hour early at 11:00 and saved the city with this cunning trick. To remember this historical event, every day at 11:00, people can put their hands inside the clock and catch a commemorative glass marble that is dropped from the inside. So if you see some people standing there at 10:00, don't be surprised! Everyone wants to try their luck and places at the clock's design is its protective wrapping.

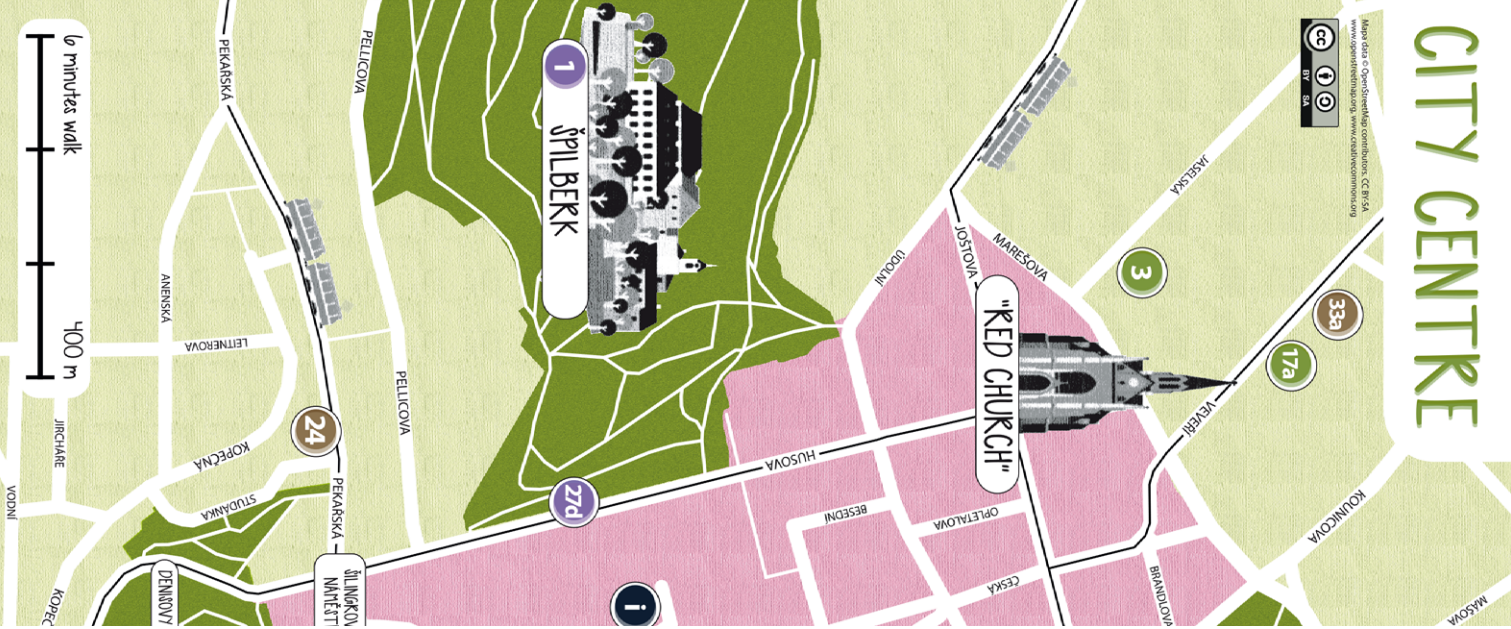

We love and support our hockey team **Komete**, even during the seasons when they suck. Also, if you were born and raised in Brno there is no way in hell you will ever move somewhere else, and definitely not to Prague.

## Food friendly

We have quite recently discovered that besides **svíčková** or **knedlo-vepřo-zelo** there is a whole 🌍 of flavours for us to taste! A significant part of Brno's gastronomy is actually Vietnamese cuisine. Many Vietnamese citizens decided to stay in Brno after 1989 as the opportunities were more favorable here. They started their own restaurants and we didn't need much persuasion to love Vietnamese food. Visit the Vietnamese market in Olomocká street and experience a little piece of Vietnam in Brno.

## Self-deprecating humor

We are fond of our astronomical clock even though we can't read time from it. We defend our statue of bally Jobst on a horse, but we still show tourists the right spot to take a selfie that will reveal all the giraffe's sorry, horse's secrets. We are even proud to live in the suburbs of Vennai! Your jokes can't really hurt us.

## Bonding with strangers

You haven't been in Brno if you haven't joined us on the **N-bus**! Especially on Wednesdays (students' party night) or weekend nights, our night bus is a carnival of lost souls, crazy conversations and plain fun! The N-buses run every hour from 23.00 to 05.00, all of them via Hlavní Nádrazí.

window overlooking the Jozefská street and have a cup of coffee accompanying your pastry.

**Jozefská 7** - Non to Fri 07.30-18.30  
**Joazeška 7** - Non to Fri 07.30-18.30  
**Hozoký 7** - Non to Fri 07.30-20.00

## 5 Foodcheck



Why is there so often a line of people at **Zehy** th? The thought they're queuing for bananas? (ask the locals if you are not sure what that means) might cross your mind but that's not it. Follow that line and you will discover a cozy courtyard with a food truck. Meet **Bibček**, with its signature pork, beef, burgers, crisp fries (fried in lard) and tasty cakes. Try their pulled pork burger or just take the fries and have them right here, sitting on the square.

**Zehy** th. 325/18 - Tue to Sat 11.30-until sold out

## 7 Shot of gin is not a sin

**7 Hečko (7 sins)** is where you can find the greatest gin and tonic selection in the city, but that's just the start. They really know how to mix a drink, and they have their signposts inspired by the seven deadly sins. Do you feel like nurturing your pride or greed tonight? During the day, they also run a patisserie, which allows for endless possibilities of treats pairings.

**Jukáská 7** - Tue to Thu 18.00-02.00, Fri to Sat 18.00-03.00, Sun 19.00-02.00

## 9 Fittings, art & beer specials

You can still feel the industrial vibe in the east and south of Brno, and **ŠKOTI** is a great example of how to bring a new life to a former fittings factory. Opening in a small room with arcades and walls covered by computer chips you'll get to a pub full of iron art and a wide selection of specialty beers. Don't forget to have a look at the Back, where you can find a gallery and small garden.

**Křenová 10** - Non to Fri 15.00-01.00, Sat 17.00-01.00, Sun 17.00-00.00

remember this historical event, every day at 11.00, people can put their hands inside the clock and catch a commemorative glass marble that is dropped from the inside. So if you see some people standing there at 10.00, don't be surprised! Everyone wants to try their luck and pieces at the clock are limited. Another curiosity connected to the clock's design is its protective wrapping. On New Year's Eve, the clock is wrapped up as protection from the fireworks, which transforms the unusual thing into a giant tampon.

## 6 Beer nerds go there

Are you indecisive with too many beer options? Don't even try to go to **AXONI** then, as the draft beer and cider specialty selection seldom goes under fifteen, many freshly brewed by the crew just a short drive out of Brno. Luckily, the choice is easier with food options, as there's not too much besides their legendary *Fleischkuchen*, which we totally recommend.

**Pátňáková 3** - Non to Tue 16.00-00.00, Wed to Thu 16.00-01.00, Fri 16.00-02.00, Sat 15.00-02.00, Sun 15.00-22.00

## 8 I can hear the bells chime

When walking in the city centre, you will notice a wide range of sacral buildings. The **CATHEDRAL OF ST. PETER AND PAUL** (also known as **Petrov**), is easily recognizable and the most prominent feature of the city, located on Petrov hill. The gothic facade of the cathedral creates a strong contrast with a sober interior. To maximize the experience, visit the Sunday morning mass that is accompanied by a choir. You can also enjoy the view from the tower or visit the crypt (30-40 CZK).

**Petrov 1** - Mon-Sat 10.00-18.30, Oct-Apr 11.00-17.00

## 10 For your inner pirate

Rum bar **Guland** in the centre of Brno is a place with a great selection of rums and cocktails. Just "sail" inside and enjoy a great evening atmosphere in the pulsating heart of city.

**Jozefská 7** - Non to Thu 16.00-01.00, Fri 16.00-02.00, Sat 18.00-02.00

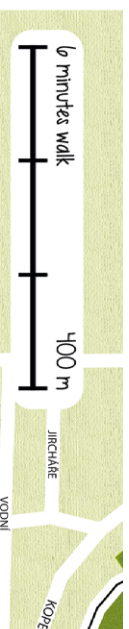

## Coffee + Brunch = Brno

The influence of nearby Vienna is quite visible in this aspect. We are bursting with joy a crackling, sizzling and dripping sounds of the coffee machine while our top notch favourite caffeine drink. And Brno loves brunches! People got used to the idea of this mash-up are many wonderful places where you can enjoy your mimosa and a delicious breakfast plate.

### 11 Pancakes with abs!

**KAFÉ** is known for a wide variety of breakfast deals and a chance to create your own breakfast plate (or if you can't decide you can try their special seasonal waffles that are simply delicious), in combination with specialty coffee, roasted by local companies. Since the original place near the House by the Stone Virgin became popular (tends to get crowded on the weekend mornings) last year they opened their second location on Vozov street.

**On Vozov 120** - Non to Sun 08.00-20.00

### 12 Cozy little universe

If you feel under the weather and want to soothe your soul, **café Kailiá** is the best place to go. A little cozy place near the university buildings and libraries, it offers shelter not only to the students on their study break, but also to people who want to take a break from their stressful day and boost their energy levels with some caffeine and snacks. From sweet pastries to our specialty *chlebíček* (open-faced sandwich in different varieties with delicious toppings), everything is served with a great amount of love and care on the side.

**Nerudova 8** - Non to Fri 09.00-18.00

### 13 All the good st

Café bar bistro **1FOKOLÉ**, with its signage midnight) on the wall, is a good choice afternoon, coffee or evening drinks spend your whole day here. The espresso Benedict are so delicious that you will want to make your experience perfect ready to make your experience perfect Floral wallpapers, grandma's tea sets books, coffee, and freshly cooked bread, heart of the city centre. **Kafé v rožku** couple of brunch lovers. They have fu opening a bistro-style coffee house, and childhood nostalgia. Try their bre as a bagel or sourdough bread with eggs.

The surname of the owner and the so Pontius Pilat, inspired the menu and c Let the birds on the walls be your enjoy your brunch or the lunch menu Czech wine, Sicilian coffee or more: yourself back to Paradise.

**13a** 1FOKOLÉ - Václavka 6 - Non to Sun 07.30-20.00

**13b** KAFÉ V ROŽKÁDĚ - Vezelá 1 08.00-22.00, Sat to Sun 09.00

**13c** Café PILÁT - Kapucinská nám. 3 08.00-22.00

# Y CENTRE

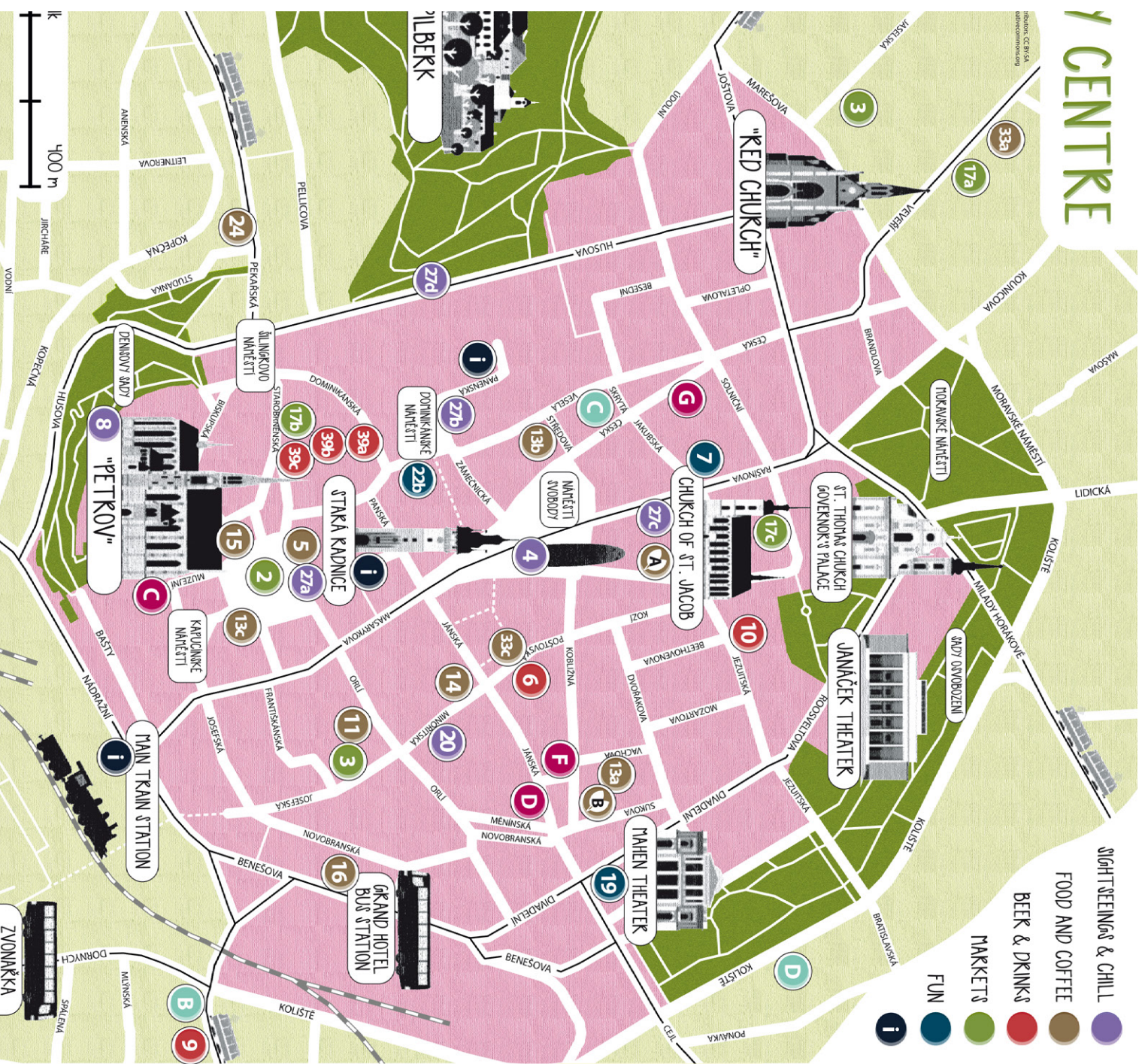

- SIGHTSEEING & CHILL
- FOOD AND COFFEE
- BEER & DRINKS
- MARKETS
- FUN
- INFORMATION

## Where next?



Current covid measures related to travelling and daily life can be found at <https://covid.gov.cz/en/>

**Airport Bus**  
Only 20 minutes ride from the station  
Bus 76 -> from 05:30 until 23:30 -> from the main train station every half hour (00, 30)  
Bus N94 -> at night -> from the same point every hour, on the hour

To the next city  
For public transport schedules use -> [idat.cz](http://idat.cz) or mobile app 'Vizualizace Káď' National and international trains and buses -> České dráhy, Regiojet or FlixBus websites

For cycling lovers  
Cycle map -> <http://www.bronnajakole.cz/cyklomapa-brno/> 'Káďička' -> communal pink bikes available on the streets (April to November)  
[kreditik.cz](http://kreditik.cz) -> mountain bikes, scooters upon reservation -> +420 776 76 77 75  
Mon-Sun: 9-11 a.m. & 5-6 p.m.  
They will transport bikes to you

## Public transport

Cash: yellow ticket machines (at some tram stops), newspaper shops, from the driver (slightly more expensive)  
Card: yellow ticket machines at *Ilavni Nádrazí* and *Palňovského náměstí* stops, directly in the tram (tap your card against the reader to check in, for journeys shorter than 15 min do not forget to check out) works only with Visa and Mastercard or Googleplay and Apple Pay  
SMS: CZ phone numbers only! text: "BRNO20" (20 min/20 CZK), "BRNO" (75 min/29 CZK), "BRNO\*" (24 hours/99 CZK) to 90206  
App: "DPMBinfo" (android & IOS)  
Prices: 90 min -> 27 CZK 15 min -> 20 CZK 60 min -> 25 CZK 24 hours -> 90 CZK  
TIP: At the weekends you can use a single 24 hours ticket for 2 people. Long term pass can be bought in DPMB office at Novobranska 18 (closed on Sun).

## Infopoints

Kadnická 8  
Daily 09:00 - 18:00  
Panačská 1  
Daily 09:00 - 18:00 + luggage office



## Practical information

**Meeting points**  
Around 19:00 or 20:00 these places are quite crowded (especially on weekends)  
• The main train station (or "nádř")  
• Under the clock on *Čestlá* (or as locals say "čard")  
• The "cock clock" on *Náměstí Svobody*  
• The sculpture of *Václav of Florová*

## Hantec dictionary

**Čalovat** [čalovat] -> to pay  
**Prigl** [prigla] -> Bino dam  
**Frk** [frk] -> joke  
**Čalška** [čalška] -> food  
**Love** [love] -> money  
**Krygl** [krygl] -> pint of beer  
**Koc** [koz] -> woman  
**Nabeton** [nabeton] -> definitely  
**Šalina** [šalina] -> tram  
**Prča** [prča] -> fun  
**Štati** [štata] -> city centre  
**Čajz** [čajz] -> inhabitant of Prague

## Smoking NOT allowed

Smoking inside (restaurants, theatres, cinemas, etc.) and on the tram/bus stops is banned.

## Alcohol

• On streets or in parks, drinking alcohol is officially not allowed (but, actually, we do drink in parks).  
• In bars and on terraces you can drink whatever you want if you are over 18!  
• Outside terraces usually close at 22:00 but then you can continue inside the pubs.





## + Brunch = Brno



Brno is quite visible in this aspect. We are bursting with joy as we listen to the sizzling sounds of the coffee machine while our top notch baristas prepare our drink. And Brno loves brunch! People got used to the idea of this mash-up meal and these places where you can enjoy your mimosa and a delicious breakfast plate.

## 14 Quality before quantity

Known for a beautiful functionalist design, their first class service and delicious cakes, **café PLÁZEK** is definitely a must visit in Brno. The name itself implies its connection to the Jewish history of Brno - the building was designed by the famous Elser architectural company. It was chosen to commemorate the Plázeck family, one of the most influential textile dynasties in Brno in the beginning of the 20th century. We should never forget that Brno would not look the same if not for the textile industry magnates that shaped the architecture to the way it is today. Just like the Plázeck family preferred quality over quantity, the same can be said about the café - their carefully chosen menu, homemade pastries and desserts, quality coffee with gluten and lactose free options included. To prolong your experience here, you can choose to stay in their 888 Plázeck.

## 13 All the good stuff

Café bar bistro **1FOKOLÉ**, with its signature Love sign (after midnight) on the wall, is a good choice for brunch, lunch, afternoon coffee or evening drinks - basically you can spend your whole day here. The espresso machine and eggs Benedict are so delicious that you will not want to leave this place. Experienced bartenders and nice waiters are ready to make your experience perfect. Floral wallpaper, grandma's tea sets and the smell of old books, coffee, and freshly cooked breakfast. Hidden in the heart of the city centre, **Kaife v rozkladu** is the lovechild of a couple of brunch lovers. They have fulfilled their dream of opening a bistrot-style coffee house, inspired by Art Deco and childhood nostalgia. Try their breakfast options, such as a bagel or sourdough bread with scrambled or Onsen eggs.

## 15 Aviation fascination

Another place in Brno where you travel in time is the **Air Café**. The design of this place tells the story of Czech pilots in the Royal Air Force. Air café is also a part of the Moravian Museum and there is a beautiful view of the Petrov cathedral from the courtyard inside.

## 16 Coffee with some thorns

Are you the one who is satisfied with only the best coffee? **The Kozák**, a small and cozy coffee place got you covered! **Benešova 403/8b** - Non to Fri 07:00-19:00, Sat to Sun 08:00-18:00

## Little universe

weather and want to soothe your soul, get place to go. A little cozy place near us and libraries, it offers shelter not on their study break, but also to take a break from their stressful day and pastries to our specialty **chlebíčků** rich in different varieties with delicious igs is served with a great amount of love

- 13a 1FOKOLÉ - Vahovská 6 - Non to Fri 07:30-21:00, Sat to Sun 07:30-20:00
- 13b KAFE V KOZKLANU - Vezda 172/6 - Non to Fri 08:00-22:00, Sat to Sun 09:00-22:00
- 13c Café PLÁZEK - Kupařská nám. 303 7/7 - Non to Sun 08:00-22:00

## 17 Souvenir Crazy? We are!

We all love to get a little something from our trips to keep the memories from holidays alive. Here are some of our hottest tips for local stores where you just might find the right thing. A small gift shop **U To Mlé** sells wooden toys, beautiful stationary and handmade jewellery. You will fall in love with the place the second you walk in. Wanna spice up your life? Then **The world of chilli** is your must-go place. Definitely try the delicious chocolate or jam spiced with the chilli peppers that are being grown in South Moravia. Or if you prefer savoury taste, have a taste of the pickled peppers. Just beware of setting your mouth on fire.

The main idea behind the **Flax store** is to promote sustainability and craftsmanship and to support Czech and Slovak independent designers. Get your hands on the one of a kind hand-made stuff from clothes and cosmetics to jewellery.

To get authentic Brno souvenirs, visit the **Tourist information centre** gift shop. A glass marble from our astronomical clock, mugs with the design dedicated to each city district or a tote bag with "Salina" - these are just some of the memorabilia that will remind you of your stay in this beautiful city.

- 17a JE TU MLE - Vevří 4 - Non to Fri 10:00-18:00, Sat 10:00-18:00
- 17b The World of chilli - Štefánikova 20 - Non to Fri 10:00-18:00
- 17c Flax store - Hornavík náměstí 4 - Non to Fri 09:00-19:00, Sat 10:00-16:00
- 1 Tourist information centre - Hornavík náměstí 4 - 1000-18:00



Šalina [šalajna] -> tram  
Prča [prchal] -> fun  
Štátí [štatel] -> city centre  
Cajzl [cajzel] -> inhabitant of Prague  
Kaití škopky [kaití škopki] -> drink beer

## 18 Traditional Czech cuisine

Travel back to the time of Franz Joseph I and enjoy a traditional Czech or Austrian meal at **Historie U Šermířů**. Try the Czech classic, old Bohemian style tendleton in a vegetable-based cream sauce with dumplings and cereales (198 CZK). Having a beer is a must and you should definitely have a taste of their Pilsner tank beer, if only to hear the porcelain beer coasters clink.

**Wahovská 30** - Non to Wed 10:00-23:00, Thu to Fri 10:00-00:00, Sat 12:00-23:00, Sun 12:00-22:00

## 19 Not just a regular gallery

If it's contemporary art you're looking for, then visit the **Brno House of Arts**, an institution that has been in Brno's cultural life for over a hundred years but always kept up with the times. The temporary exhibitions will take you from architecture through painting, sculptures, artistic installations, and photography.

**Hornavíkovo nám. 2** - Tue to Sun 10:00-18:00, Entry 100 CZK

## 20 A hidden beauty

Less noticeable from the outside, but very remarkable from the inside, is the baroque **Thronite church of Saint John** with a beautiful Lorenzo Chapel and Holy Seals, that should remind us of the stasis that Jesus Christ climbed in Jerusalem's Palace to reach Pilate. If you are travelling around Christmas, every year there is a giant Nativity Scene exhibition on display in the main part of the church.

**Thronitka 1** - open daily, the times may vary depending on the season

(in parks)  
• In bars and on terraces you can drink whatever you want if you are over 18!  
• Outside terraces usually close at 22:00 but then you can continue inside the pubs.

## Brno legend by Tadeáš Buttl won!

In a city split between groups with diametrically opposing ideas you can expect real problems. But you can also expect many really petty feuds. The legend about The Indecent Man is certainly one of them.

In the 16th century, two large communities in Brno, Czech and German, refused to share one church. So it only made sense for them to build two churches instead of one. Germans would build the Church of St. James and Czechs the Cathedral of Saint Peter and Paul. One version of the legend says that Czechs were jealous of the skilled German architect. So they decided to banish him from the city. Strangely, the architect calmly accepted his punishment. However, before he left, he was granted one last wish: to design one of the final windows of the church. This seemingly innocent wish led to a big surprise for the Czechs when a small statue of a man hanging off the window ledge exposing his butt towards the Czech cathedral appeared in the window of this sacred place. Another newer version claims that the statue was built there because the builders of both churches made a bet about who would build a higher bell tower. And Germans and their weird sense of humor won. So, whether the statue was petty revenge of an angry German architect or simply a celebration of the German victory in a bell tower measuring contest is not sure. But what is certain is that The Indecent Man and his naked bottom will stay there in all its glory for a long time.



UNIVERSITY OF BRNO, THROUGHOUT THE CITY CENTRE, PROFESSIONALS AND AMATEURS ENTERTAIN PEOPLE WHILE THEY ARE ENJOYING THEIR WALKS OR DELIBERATELY COMING FOR THE MUSIC SESSIONS. JUST CHECK <https://www.muzikatorihubdy.cz> FOR MORE DETAILS.

**THE YEAR OF MENDEL 2022**, since it is the 200<sup>th</sup> birthday of G. J. Mendel, many workshops, lectures, exhibitions and other events are going to take place all over the city. If you want to discover more about this amazing scientist, definitely come for the Mendel Festival from 23<sup>rd</sup> to 25<sup>th</sup> July 2022.

Our tip: Don't wanna miss anything important? Check [www.gotobrnocz](http://www.gotobrnocz) to keep you up to date with all the important events!

WWW.USE-IT.TRAVEL



USE-IT is tourist info for young people: made by locals, no-nonsense and up-to-date. Want to be the first to know about our new maps? Then like [www.facebook.com/USE-IT](https://www.facebook.com/USE-IT)

Graphic design: Kamil Sobek  
 Content: Lucie Polvavska, Kamil Sobek, Pavel Somogyi, Gabriela Vychova & Martina Nemcova  
 Proofreading: Anna, William & Jozien  
 Published by: USE-IT Brno, z.s., June 2022, Brno



This project is financially supported by the city of Brno

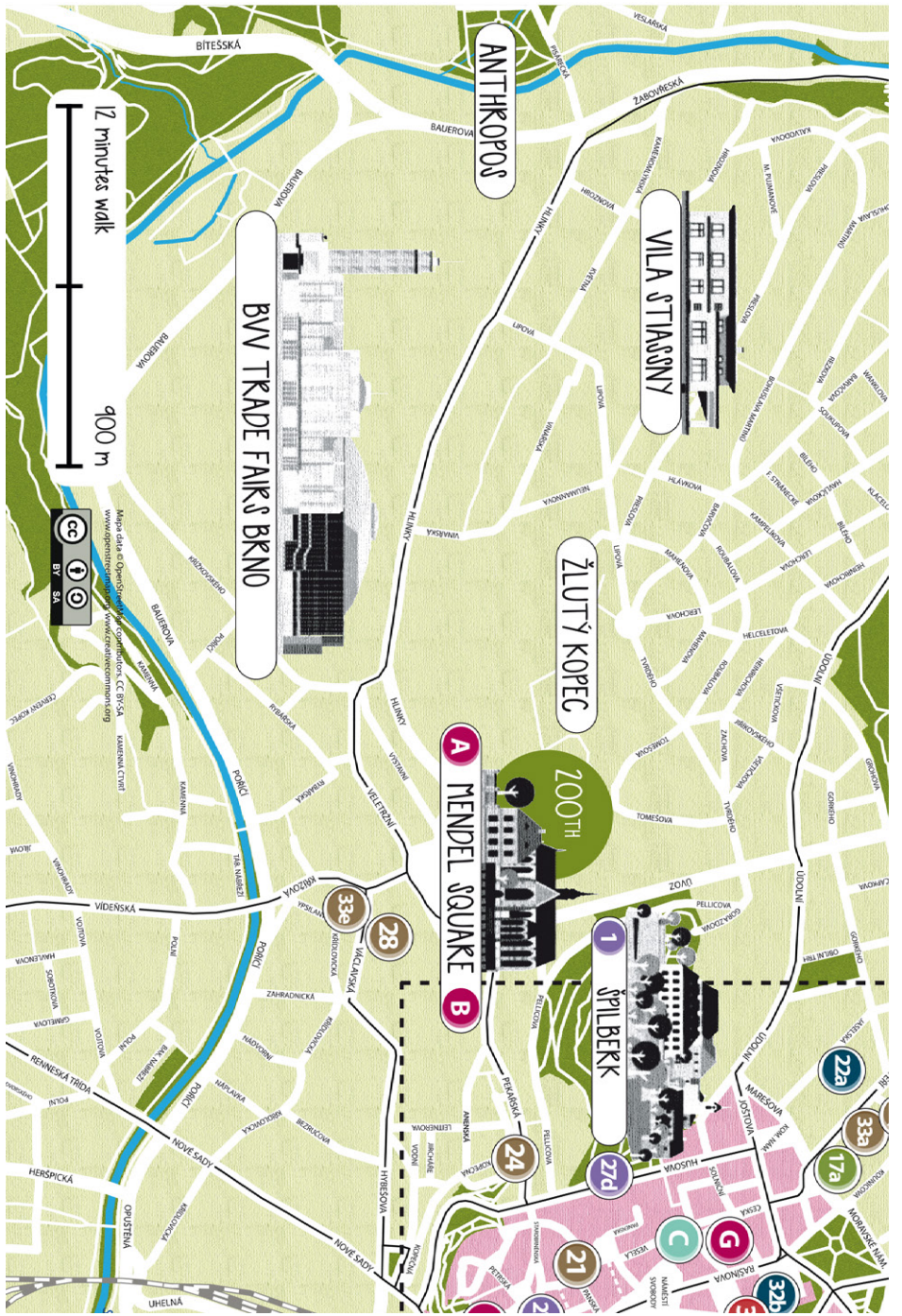

## Underground

Don't serve the public transport, but ground corridors, crypts, and cellars. In **underground** **Leány** (It's a system of wine cellars. **THE TINT TANKERS** If the history of the minting craft in city square by horror movies, visit **THE SINKER**, the resting place of a plague, cholera and the Swedish army who were all placed here when in the cemetery. The last stop can be seen in the **TER** 10-2, under Špilberk Castle. It's a rarely it's never been used for that

Thy Th-21 - Tue to Sun 09:00-18:00, 18:00-21:00

DK - Dominikantský nám. 1 - Wed to Mon 09:00-18:00

FAT JINTEK JINTEK - Jiráskova nám. 30-18:00, Emly 70-19:00

TER 10-2 - Husova - Tue to Sun 16:00-19:00

## 28 Noodle time

Stepping into the simple interior with noodle-like lamps, you can smell the warm soup and hear Japanese pop-music in the background just to make you feel like you really are in some small bistro in Tokyo. Don't be fooled, you are still in the old town, in **Brno**. There are three types of ramen on the menu to choose from (one veggie option) and always friendly staff ready to help you explain how ramen is properly eaten. The place tends to be crowded at lunchtime but it is definitely worth the wait.

Valdická 16 - Mon to Fri 11:00-19:00 and 17:00-20:00, Sat & Sun 11:00-19:00

## 29 Absinthe den

There is no other place in Brno with such an impressive collection of absinthe as this underground bar. It is served traditionally - using a fountain, but don't expect anything fancy... The design of this bar was mainly influenced by the surrealistic naughtily street-art. If you want to try absinthe from a Czech family distillery, order something from **Zlatáček**.

Jana Ulbrá 3 - Daily 16:20 until morning hours



Local tip from Pavel

## 32 For film lovers

Don't expect a multiplex popcorn entertainment centre. Instead, these are true blue cinemas with a soul and long history, where people of all ages meet to grab a beer (or a soda), and go see a movie. **KINO ŠKALA** was made for industrial workers in the late 1920's, and nowadays is owned by Masaryk University, although it's not only for students. A little bit further from the centre, situated in a functionalist building is **KINO AKT** - a cinema, café and a gallery all under one roof. In both cinemas, you will find new movies, as well as the classics and various festivals that glorify different countries and genres. Just don't expect the biggest blockbusters. The cinemas are dog-friendly, if they're well-behaved dogs. Programme is online:

32a KINO AKT - Chládkova 19 / www.kinoakt.cz/en

32b KINO ŠKALA - Novácká nám. 3 / www.kinoshkala.cz/en

## 34 Picnic time!

What could be better than a picnic in a park? Bring your own blanket or sit on one of the park benches and enjoy a sunny day with your friend or your dog. In the middle of **BRNO**, a shipping container serves as a small café - **PIKNIK BOX**. The friendly staff will prepare coffee, tea or freshly brewed beer. And what would be a picnic without a freshly baked cookie, cake, or toasted sandwich with tomatoes and mozzarella, in the second container, you will find nice and clean toilets.

Brno, 1st - Summer: Mon to Fri 09:00-20:00, Sat to Sun 09:00-20:00, Winter: Mon to Fri 10:00-18:00, Sat to Sun 10:00-18:00

## 33 Sweet, sweet life

Craving a piece of cake? We have you covered! Firstly, start with Czech pastries, like **štroupek** or **špaldka** at **MAKTYNKA**, where they focus on traditional cakes and sweets. Then you can put the best cheesecake in Brno with specialty coffee from the Watermelon sugar cake (**WATERMELON CUKRUKI**), get a cup of real chocolate with home-made ice-cream from **NIMNICH** chocolate factory, enjoy a delicious brightly coloured mini-cake in a geometric shape from **ČUKRUKÁTKY KREKENTY** or try a piece of cake with some unconventional flavour like dust, ground mayo or beans from **ČUKRUKÁTKY FLEUR DE PÂTE** (don't be afraid, they are all delicious).

33a MAKTYNKA - Veverčí H - Mon to Fri 08:00-17:00, Sat to Sun 10:00-18:00 or Rátová 4, Mon to Sun 09:00-18:00

33b W WATERMELON CUKRUKI - Františkova 17 - Mon to Sun 10:00-18:00

33c NIMNICH - Rátová 4 - Mon to Fri 09:00-17:00, Sat 10:00-18:00, Sun 11:00-18:00

33d ČUKRUKÁTKY KREKENTY - Dvůrníkova 28a - Mon to Sun 09:00-17:00

33e ČUKRUKÁTKY FLEUR DE PÂTE - Křídlovická 32/1 - Mon to Sun 10:00-20:00

## 35 Save water drink wine

If you like wine, **WINE WINE** was just made for you. This wine shop serves top-scored wines from Moravia and also some foreign bottles are sold here. You can stay outside even in cold weather thanks to outdoor heaters and blankets, or you can just buy a bottle to go.

Koháček 26 - Mon to Fri 01:00-24:00, Sat to Sun 16:00-24:00

## Eat Green

While Czech cuisine is heavy and rich in meat, don't worry... there are enough places where you can enjoy light, vegetarian or vegan foods. Too, the most iconic one is **FOCKY**, located on Jakubšova náměstí. If you are amazed by the historical interior with the oxys stairs, know it was a café from 1929 under Jakubšova náměstí. If you are smitten by WWII, you can find a wide range of modern vegan dishes there, for a little over the average price. If you prefer something a little less posh, there's **DIÉ KUCHĚ** just three blocks away, offering a vegan daily menu, afternoon snacks, and early dinner. Then it turns into an alternative music club in the evening. **VEGETABLE** also hosts concerts from time to time, but they usually cook till late evening, focusing on Czech vegan and vegetarian dishes, and also their own beer. On the same street you can find **OVIVA** as well, offering breakfast, and also the cheapest lunch in town, which is, despite its low price, of a very decent quality. As a vegetarian menu, **TRI ÚSMĚV**, vegan community club, and **PLÁNKIN**, serving high quality vegan dishes.

A FOCKY'S - Jakubšova náměstí 1 - Mon to Sat 09:00-21:00, Sun 09:00-18:00

B DIÉ KUCHĚ - Štefánikova 4 - Mon to Fri 11:00-19:00, Sat 12:00-18:00-01:00

C OVIVA - Štefánikova 2 - Mon to Fri 07:30-18:00

D 607PL - Trhová Kapřina Ulice 10 - Mon to Fri 11:00-18:00

E TRI ÚSMĚV - Trhová Kapřina Ulice 18 - Mon to Fri 11:00-22:00

F PLÁNKIN - Trhová Kapřina Ulice 26 - Mon to Thu 11:00-16:00, Fri 11:00-21:00, Sat 12:00-20:00



Local tip from Gabriela

## Vegetarian BOX

## 36 Underground is still alive

Imagine a place which combines a bar, a theater, a concert hall and a favourite meeting place for you philosophical debates. Hard to picture it? Check out a truly multicultural **AKTIVNÍ DŮM**. We recommend their **Janáček pro děti** (a short for hard bitten ones) or if you are brave enough, open the door to a spacious room where their own punk theatre group might be performing, or a pub quiz or Brno night takes place. It is not only metaphorically, but also literally an underground pub. Entry price is voluntary.

Štefánikova 1 - Mon to Thu 18:00-01:00, Fri to Sat 18:00-03:00

## 38 Everything from planets to clocks

Adults, teenagers or kids, everyone who is curious about how things work and are made, are all welcome to **TECHNICAL MUSEUM**. It offers 16 permanent displays and a playroom where you can learn about different laws of physics and even try them yourself. You can also visit a wide range of workshops and events (which change seasonally) and some of them are even online! where you can for instance try to melt some metal and create a small souvenir you can take home as a gift. The museum also has six signs outside of Brno, which are open from April to October.

Parkhova 105 - Tue to Fri 09:00-17:00, Sat to Sun 10:00-18:00, bank holidays 10:00-18:00 Emly 50-120 Kč (can be booked online)

38c MALT WORKN - Staroměstská 13 - Mon to Tue 16:00-24:00, Wed to Sat 16:00-01:00, Sun 16:00-23:00

38d U POUŤNKA - Staroměstská 18 - Daily 11:00-24:00

38e TRONKA - Dominikantská 9 - Mon to Fri 10:00-01:00, Sat 11:00-01:00, Sun 11:00-24:00



Local tip from Martina

## E Café EKA

A beautiful blue spiral staircase, in contrast with a red shiny floor, dominates the minimalist interior of this café near the famous neighbour Villa Tugendhat. It was restored in the 2000s and it again serves the original purpose - for us to enjoy our daily dose of caffeine and delicious lunch while admiring the minimal design planned to perfection. -> Záměstská 30 daily 10:00-21:00

## F BAŤA Shopping centre

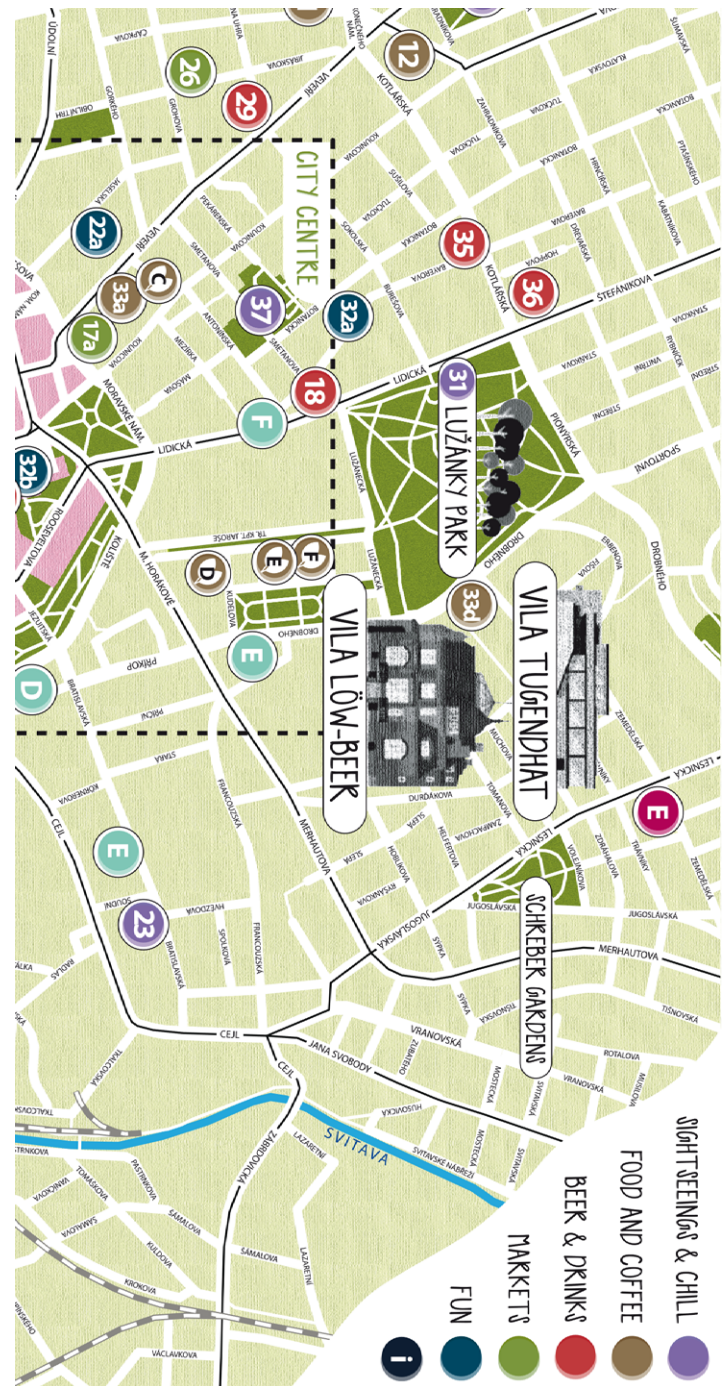

## up in praise of beer

are wasn't very special. Then **VÍTEK** (jäger = standing up) opened and it has put in the Czech Republic. In is so full of people that no-one thinks 3 themselves next to the fountain, or rgers on a curb. The best Czech beers reviewers are on rotation here. Try the menu - such as Jallari' an old isages.

11:20-23:30, Sat-Sun 11:00-23:30

## 31 It's the PARK!

Runners everywhere! Dogs just behind them! **LUŽANŤY PARK** is an oasis of calm countryside right in the city centre. Don't be afraid to sit on the grass and have a picnic, smoke some shisha, balance on a slackline, throw a frisbee around or play drunk hide-and-seek. In the trees, if you need to warm up or you feel like having a beer, check the café and restaurant **Forrad** (occasional concerts too).

Lužnická 3 - Mon to Sat 13:00-23:00, Sun 13:00-18:00

## SIGHTSEEING & CHILL

## FOOD AND COFFEE

## BEER & DRINKS

## MARKETS

## FUN



## Form follows the function

Functionalism is definitely an architectural style that formed Brno. Here are some places that are definitely worth visiting.

## E Café EKA

A beautiful blue spiral staircase, in contrast with a red shiny floor, dominates the minimalist interior of this café near the famous neighbour Villa Tugendhat. It was restored in the 2000s and it again serves the original purpose - for us to enjoy our daily dose of caffeine and delicious lunch while admiring the minimal design planned to perfection. -> Záměstská 30 daily 10:00-21:00

## F BAŤA Shopping centre

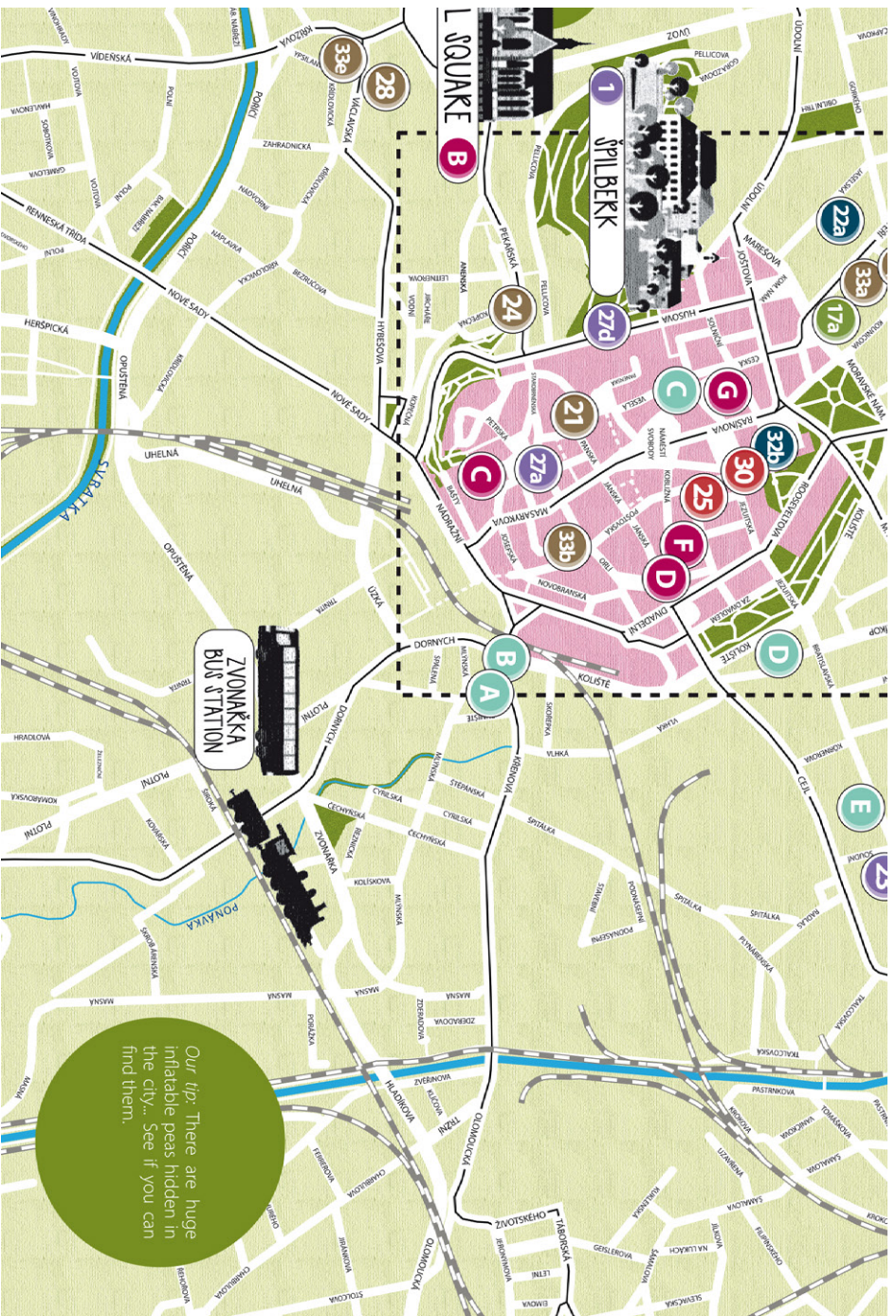

**F** famous neighbour Villa Tugendhat. It was restored in the 2000s and it again serves the original purpose – for us to enjoy our daily dose of caffeine and delicious lunch while admiring the minimal design planned to perfection. -> [Lampadiska 30](#) daily 10:00-21:00

**F** **BAŤA Shopping centre**  
Have you heard about Torrá? Babiř! Our friends from USA it Zlin can definitely tell you more about this famous shoemaker and an important personality in modern Czech history. This building at Malinovsky Square was meant to be the first skyscraper in Europe. Unfortunately due to unstable subsoil, the plans had to be changed and only eight floors were built. The horizontal stripes, distinct division of floors and white glass were the main features of this commercial building designed by Vladimír Karfík. However, times change and so has the name and purpose of the building as well as the actual design. -> [Kobliška 171](#)

**G** **Hotel Avion**  
One of the narrowest hotels in Europe can be found just a few metres from the main square. Its architect Bohuslav Fuchs wanted to make the space more fluid, using mirrors, lights and shadow to make the small space feel much bigger. For years it has been closed for reconstruction, but now is finally open! You can enjoy the interior design while drinking a beverage in the cafe or book your visit or tour at <https://www.avion-hotel.cz>  
-> [Čestlá 100/20](#) - [Čestlá+Háštka](#) open daily 11:00-22:00 (winter), 11:00-23:00 (summer)

**Our tip:** The Brno Architectural Manual (BAM) is here to help you explore the city even more! Download the map, short texts and audio and follow the white marks on the pavement on your architectural journey. Visit [www.lam.bruco.cz/en](http://www.lam.bruco.cz/en)

## A roof over your head Hotel BOX

We know that you want to enjoy as much of our city as you can, but getting a good beauty sleep is also important! Here are some of our recommendations:

For more modest travellers who can appreciate convenient locations (the main train station is just around the corner), we recommend **ŠKOKOTŤ BED AND BEER** - who wouldn't like a pub with delicious Czech beer just down the stairs? If you are more of a foodie than a beer lover, then **WAKE UP WELLNESS HOTEL** is the right choice for you - you'll love their delicious breakfasts and coffee. For less adventurous travellers who might appreciate all the amenities hotels can offer, we recommend the Brno renobles **EPH HOTEL**. There you can enjoy a spa treatment or a traditional Czech meal in the hotel's own brewery. The more conventional choice would be the amazingly renovated **HOTEL FRANKL** where you will get a royal treatment while you enjoy your morning coffee with a view of the city centre. To feel at home in Brno, try choosing **INTERNETO AKAKTENTŮ**, the private apartments in the city centre. They are known for friendly and accommodating staff with endless tips for events and activities taking place around. When looking for an adventure and a unique experience (provided you aren't afraid of hospitals), **FRANZ KAFKA HOTEL** is the place to stay. Don't get fooled by the hospital beds and historical medical equipment - it really is a place to rest your head.

- A** € ŠKOKOTŤ BED AND BEER - Křenová 10 **D** €€ FRANZ KAFKA HOTEL - Količův 43
- B** €€ WAKE UP WELLNESS HOTEL - Křenová 8 **E** €€€ EPH HOTELS WNT - 28 Kupa 23 & Bratislavská 92
- C** €€ INTERNETO AKAKTENTŮ - Vezda Hvězda 17 **F** €€€ HOTEL PANNAČE - Lidická 23